

National Campus for the Archeology of Israel 1 Aerial view of physical model

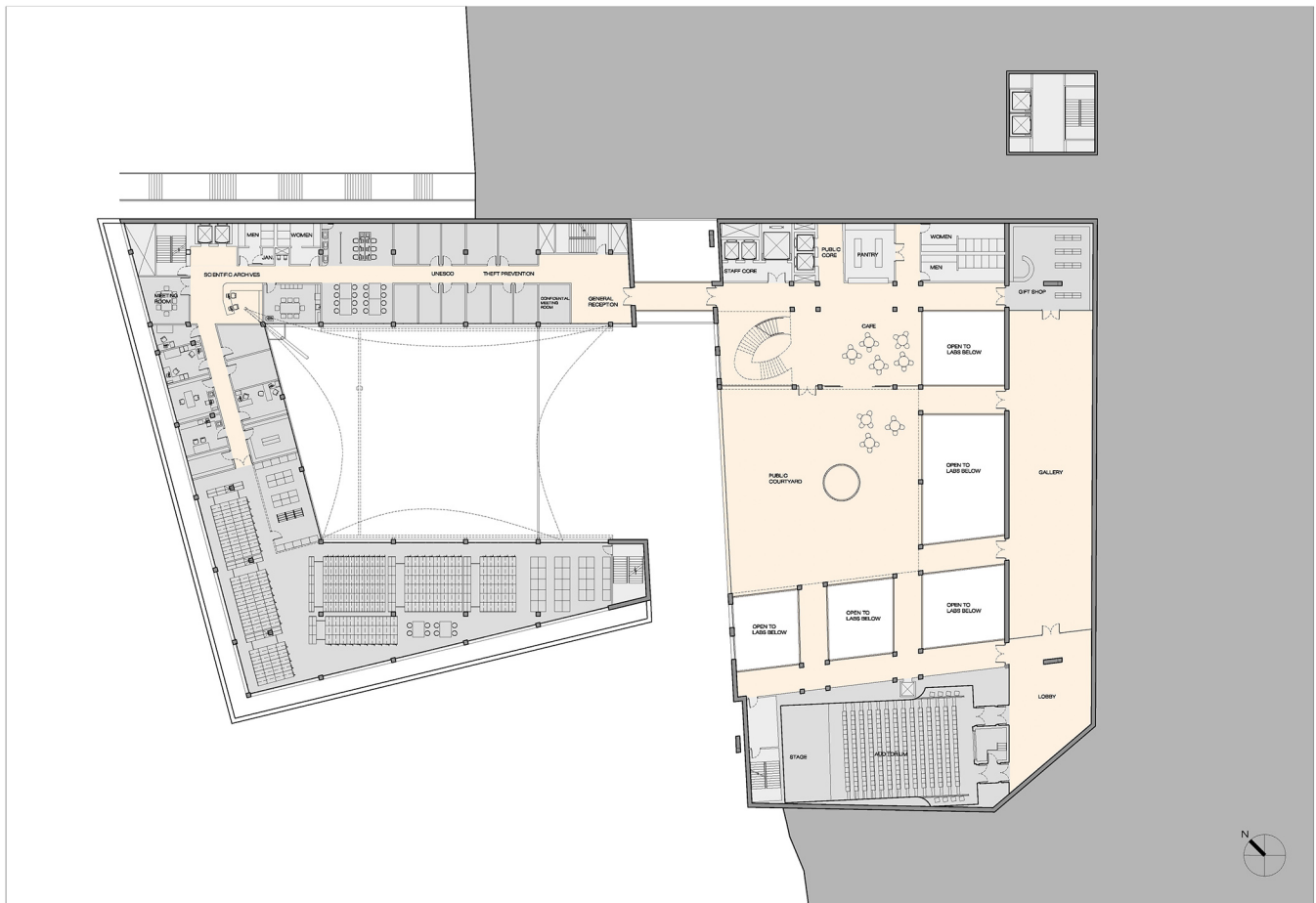

National Campus for the Archeology of Israel 2 Building elevation



National Campus for the Archeology of Israel 3 Level plan

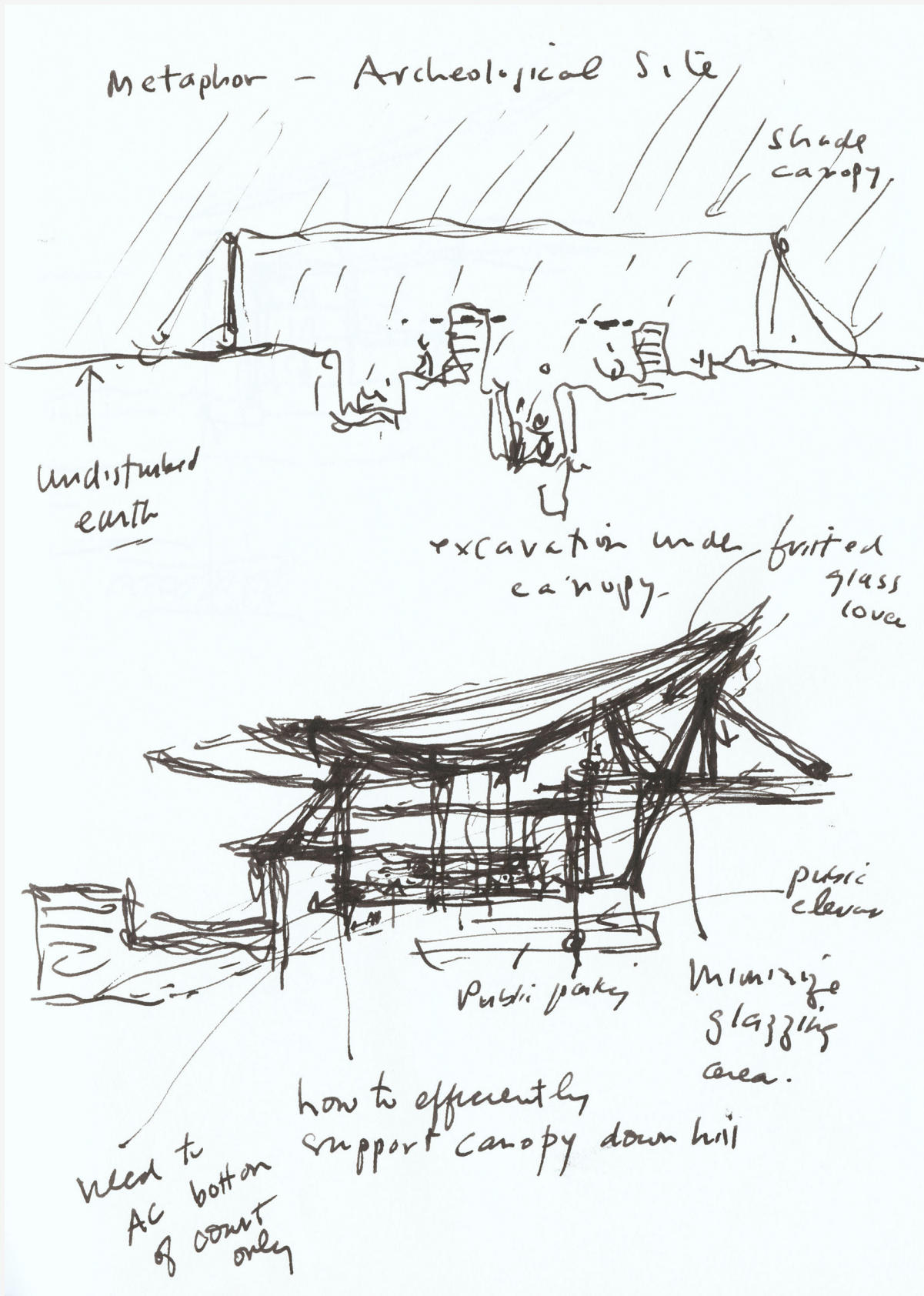

National Campus for the Archeology of Israel 4 Roof elevation studies

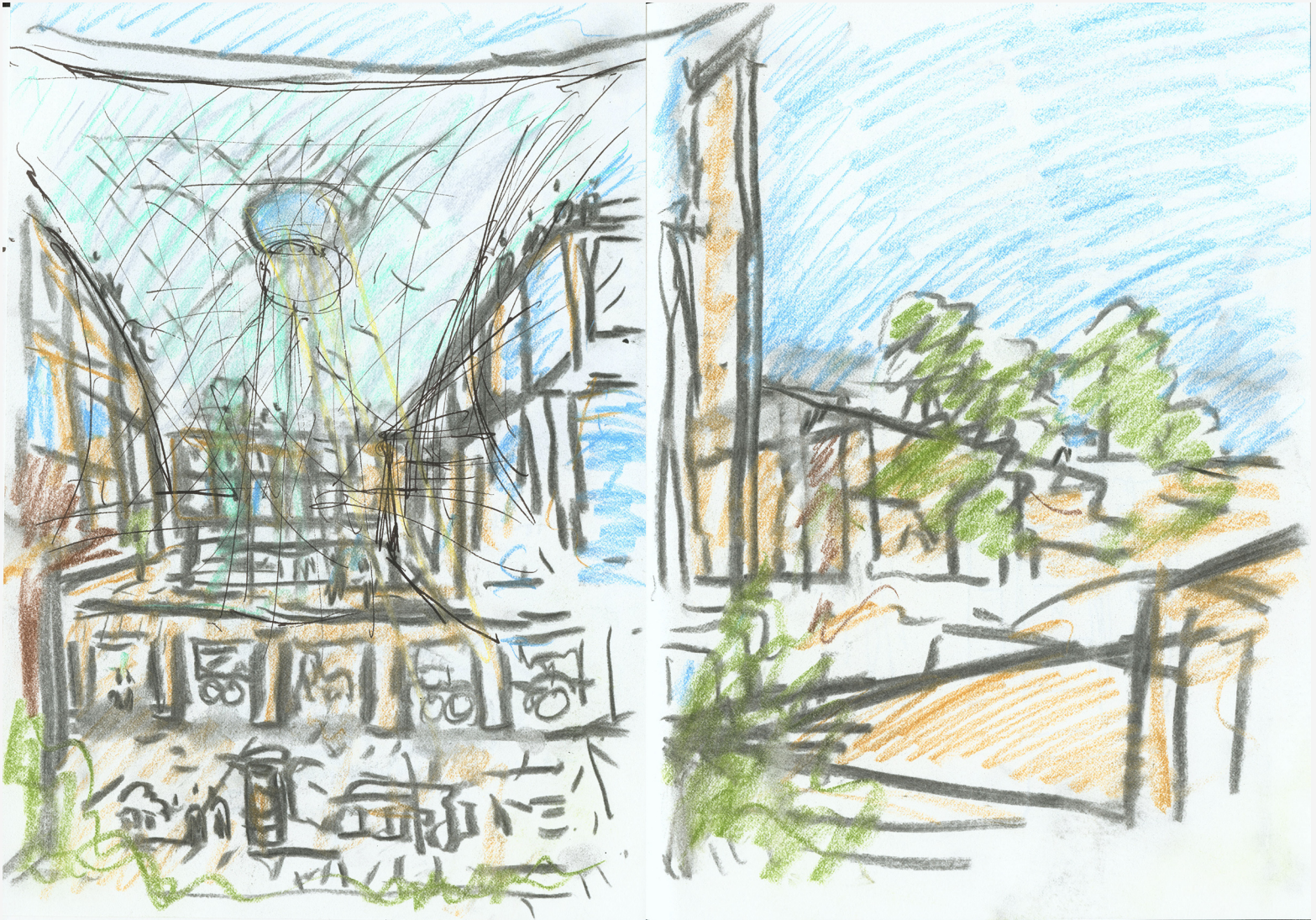

National Campus for the Archeology of Israel 5 Sketch



## National Campus for the Archeology of Israel

	<i>Image caption</i>	<i>Image attribution</i>
1	Aerial view of physical model	John Horner
2	Building elevation	Safdie Architects
3	Level plan	Safdie Architects
4	Roof elevation studies	Moshe Safdie
5	Sketch	Moshe Safdie
6		
7		
8		
9		
10		
11		
12		
13		
14		
15		

Images © Safdie Architects. Explicit permission to use images is required. Contact the Communications Director at Safdie Architects (617.629.2100) for more information.

Published by the Moshe Safdie Archive, Rare Books and Special Collections, McGill University Library, 2015.